

Site plan

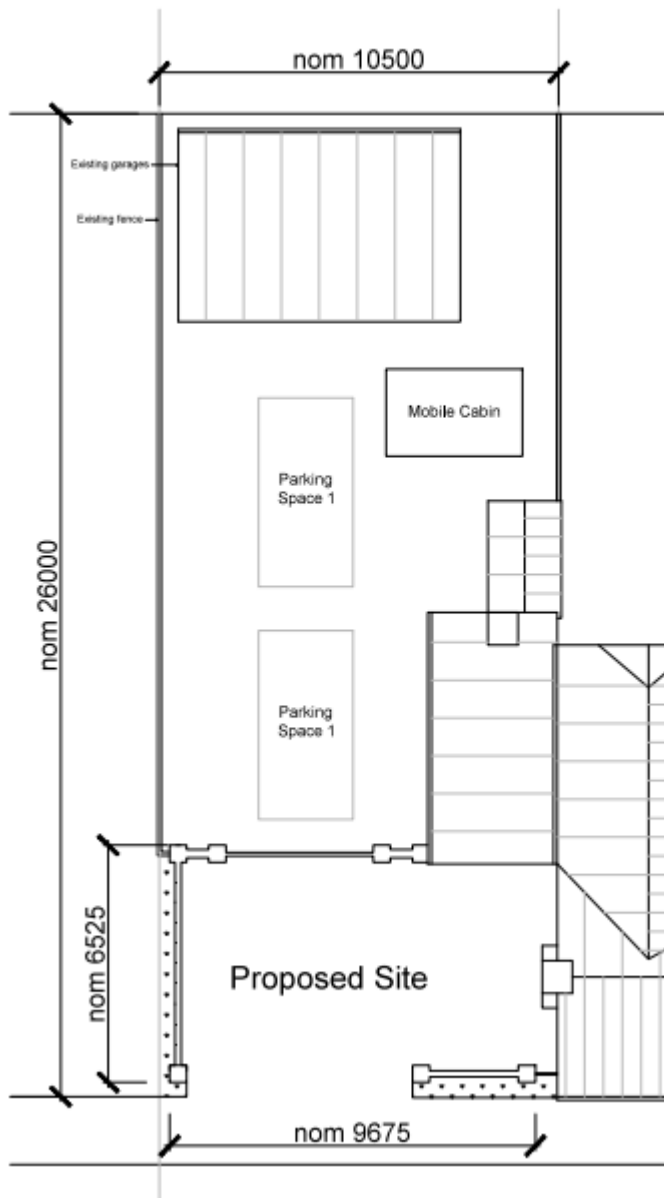

Block plan showing position of unit



ON-DEMAND, ON-SITE, ON-TIME.

ARMADILLO ECO

A HISTORY OF INNOVATION

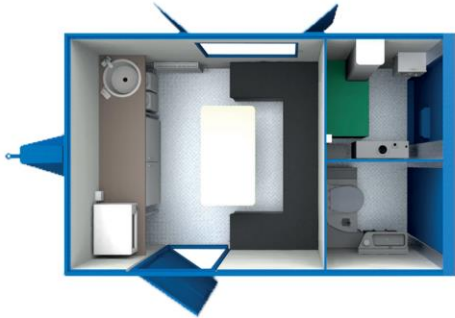

STANDARD SPECIFICATIONS:

Product Code	20601
Unit Name	Armadillo ECO
Dimensions	12 x 7.5ft / 3.6 x 2.3m
Configuration	6 person Canteen / 1 Toilet
Weight	1700kg
Water tank capacity	64L / 14gal. combined
Fuel tank capacity	68L / 15gal.
Waste tank capacity	132L / 29gal. Combined
Power type	Hybrid Solar
External rain shrouds	✓
EcoBoard internal lining to all walls	✓
12v sockets and 12v generator	✓
Low level removable lifting points	✓
Facilities (Canteen/WC/drying/changing room)	✓
Heating system and Auto frost protection	✓
Hot water (Canteen and WC area)	✓
Regulation forearm sink- WC area	✓
Chemical toilet	✓
Hydraulic chassis and towable	✓

MIN 1 WEEK HIRE

Comprising of a 6-man canteen, private WC facilities and drying/changing/generator room, the Armadillo Eco is a robust and secure mobile welfare unit suitable for even the most remote and demanding of environments.

Each eco welfare unit is solar powered and backed up by a bespoke 12v super silent generator which stops and starts as required.

KEY FEATURES:

- Road towable, self-contained secure steel unit
- Fully lockable security doors
- Canteen for 6 persons
- Auto-frost protection
- Solar powered
- Reduces fuel bills by up to £100 per week
- Hot water boiler and microwave included

OPTIONAL EXTRAS AVAILABLE

- WiFi 
- Fuel, waste & water servicing
- Water dispenser
- Additional hours pack available
- Garic i-SITE Technology

Welfare unit













Neighbour Comments

3 Wainwell Mews Lincoln Lincolnshire LN2 4BF (Objects)

Comment submitted date: Mon 12 Apr 2021

Attn: Mr K Manning - Assistant Director - Planning

I refer to your letter dated 1 April regarding the Extension of Existing Permission 2021/0731/RG3 from 31 March to 12 December 2021 delivered to me at 3 Wainwell Mews, Greetwell Gate.

My points still stand in my original email of 21 October 2020 and I would like to add the following notes of objection:

Highways Safety and Congestion

The visiting vehicles will park on Greetwell Gate if they are unable to enter the site. This will cause obstruction by either parking partly on the pavement or over the white parking area line. These vehicles will obstruct pedestrians passing, families with prams/buggies and children or elderly on walking frames necessitating them to walk in the road. Passing vehicles will have difficulty in negotiating the narrow road space and have to mount the pavement the opposite side of the road.

The way this could be avoided is for vehicles to park in the Langworth Gate car park if unable to enter the site. I understand there is also a proposed law that parking will not be allowed on pavements in the near future.

Noise Disturbance

I believe the welfare unit is to be powered by a generator. If the unit parked currently in the Langworth Gate Car Park is the proposed unit to be installed on the site then the generator makes a considerable noise when running as exhibited during last week for several hours.

I hope you will give these points your serious consideration.

Susan Mendum

3 Wainwell Mews, Greetwell Gate, Lincoln LN2 4BF.

19 Winnowsty Lane Lincoln LN2 5RZ (Objects)

Comment submitted date: Fri 09 Apr 2021

My concerns are as follows:

- 15 vehicles coming in and out per day is a lot of disruption to the local area, especially as this is a main thoroughfare for ambulances from the Country Hospital. It is a tight space on a tight and narrow street.
- pedestrians walking to all the schools in the area will be at risk of the higher

amount of traffic and larger vehicles. The intended location is on a narrow street, next to a tight corner leading into Winnowsty Lane.
- the area is a local conservation area and these facilities would not be compatible to its surroundings

Highway comments



Warren Peppard
Head of Development Management
Lincolnshire County Council
County Offices
Newland
Lincoln LN1 1YL
Tel: 01522 782070
HighwaysBUDsSupport@lincolnshire.gov.uk

To: Lincoln City Council

Application Ref: 2021/0301/RG3

Proposal: **Extension of existing permission (2020/0731/RG3) for the siting of a mobile unit for use as a temporary welfare centre until 12th December 2021.**

Location: **Land between 1 and 9-11 Greetwell Gate, Lincoln, Lincolnshire, LN2 4AW**

With reference to the above application received 1 April 2021

Notice is hereby given that the County Council as Local Highway and Lead Local Flood Authority:

Does not wish to restrict the grant of permission.

CONDITIONS (INCLUDING REASONS) /REASONS FOR REFUSAL

NO OBS

Having given due regard to the appropriate local and national planning policy guidance (in particular the National Planning Policy Framework), Lincolnshire County Council (as Highway Authority and Lead Local Flood Authority) has concluded that the proposed development is acceptable and accordingly, does not wish to object to this planning application.

Case Officer:
John Clifton
for Warren Peppard
Head of Development Management

Date: 16/04/2021